

Korky® Fill Valves

Universal Design - Fit Most Toilets

- Fit all 2-piece toilets
- Fit extra tall tanks (including Kohler® Wellworth™ and Portrait™ models)
- Fit most 1-piece toilets
- Enclosed float does not hang-up on toilet tank walls

Reliable

- Enclosed strainer catches sand/sediment to prevent clogging the critical diaphragm downstream

Easier to Install and Adjust

- One-step adjustment
- No tools required

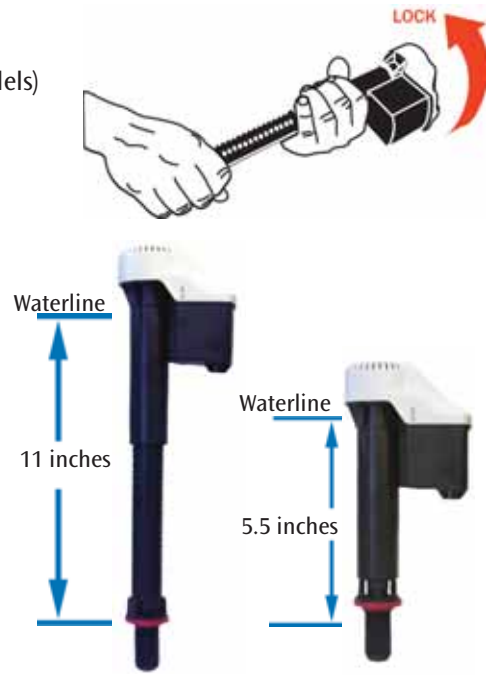
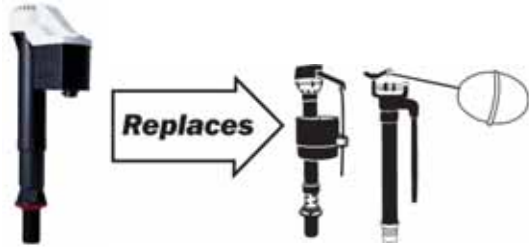

Korky® Fill Valve Anatomy

- Easy to clean and service from the top

Premium rubber diaphragm
(same as Korky® Plus)

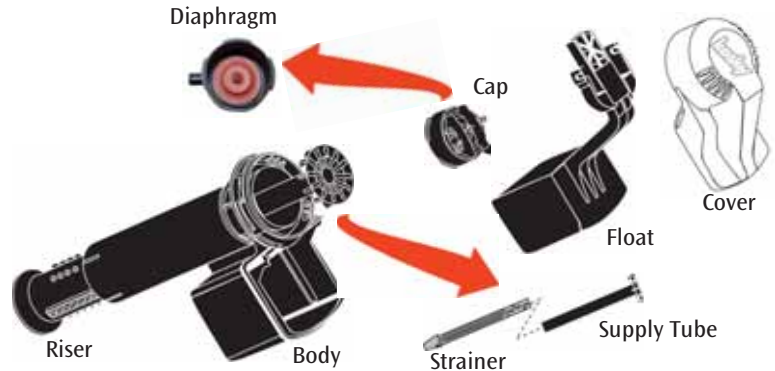

QuietFILL® MaxPERFORMANCE® Toilet Fill Valve

Ideal for toilets since 1994 (1.6 gpf or less)

- Adjustable refill delivers the right amount of water to the bowl to maintain OEM performance
 - The water % routed to toilet bowl is adjustable from 0 - 40% (Pre-1994 is 20%)
- Fits American Standard® Cadet® 3, Kohler® Cimarron® Class Five® & Six, Kohler® Wellworth®, TOTO® Drake®, & More

Fully adjustable to prevent water waste in all toilets



WaterWISE® Toilet Fill Valve

Complete Protection Against Excessive Water Loss From Flapper Leaks

- Dual Shut-off design minimizes costly water loss from:
 1. Slow Flapper Leaks
WaterWISE® remains shut off, not refilling the tank during a flapper leak. No more running toilets.
 2. Severe Leaks
WaterWISE® automatically shuts off if the flapper is stuck open or the chain is tangled (could save thousands of gallons of water).
- Convenient flush handle reset



Item	Part#	Pkg Language	Carton Qty	Packaging	UPC#
Korky® QuietFILL® Fill Valve	528	Eng/Spanish	24	Box	749306528022
	528FR	Eng/French	24	Box	049057103234

- Universal replacement for faulty fill valves and ballcocks
- Proven quietest in laboratory testing
- Easiest to install and adjust

5

Korky® QuietFILL® Fill Valve & Flapper	818BP	Eng/Spanish	12	Clamshell	749306818017
	818FR	Eng/French	12	Clamshell	049057103227

- Korky QuietFILL® Toilet Fill Valve packaged with a premium red Korky Plus flapper
- Two most commonly replaced toilet repair parts

5

Replacement Cap Assembly for 528	R528	Eng/Spanish	12	Blister	749306528039
	R528BP	Eng/Spanish	6	Blister	749306528039
	R528FR	Eng/French	12	Blister	049057103074

- Replacement cap for Korky QuietFILL® Fill Valve (p/n: 528)
- Chlorazone® rubber diaphragm
- Also fits MaxPERFORMANCE, Hunter® 528 and TOTO® fill valves

Korky® Universal Toilet Repair Kit	4010PK	Eng/Spanish	5	Clamshell	049057102923
	4010FR	Eng/French	5	Clamshell	049057103098

- Fix you leaking, noisy, or running toilet in 1 trip
- Kit includes: fill valve, flush valve, Korky Plus flapper, tank-to-bowl gasket, nuts, bolts and washers

5

Korky® QuietFILL® MaxPERFORMANCE® Fill Valve	528MP	Eng/Spanish	12	Clamshell	049057103616
	528MFR	Eng/French	12	Clamshell	049057103739

- Ideal for toilets since 1994 (1.6 gpf or less)
- Adjustable refill delivers the right amount of water to the bowl to maintain OEM performance
- Fully adjustable to prevent water waste in all toilets, including Pre-1994 toilets

5

Korky® WaterWISÉ® Fill Valve	528Z	Eng/Spanish	12	Clamshell	049057103142
Korky® Water\$AVER® Fill Valve	528ZFR	Eng/French	12	Clamshell	049057103463

- The ONLY dual shut-off fill valve for flapper leaks & hang-ups
- Minimizes costly water loss from leaks
- Universal replacement for faulty fill valves and ballcocks

5

Korky® WaterWISÉ® Fill Valve & Flapper	818Z	Eng/Spanish	12	Clamshell	049057103159
	818ZFR	Eng/French	12	Clamshell	049057103470

- Korky WaterWISÉ® Toilet Fill Valve packaged with a premium red Korky Plus flapper
- The ONLY dual shut-off fill valve for flapper leaks & hang-ups
- Two most commonly replaced toilet repair parts

5

Fits TOTO® Fill Valve	528T	English	5	Box	049057102954
------------------------------	------	---------	---	-----	--------------

- Authorized replacement fill valve for TOTO Gmax™ and Power Gravity™ toilets
- Higher refill ratio for optimum performance in TOTO toilets
- Adjustable height

5

TOTO is a registered trademark of TOTO USA, Inc.



Korky Fill Valves